

I | Com'è articolata la mostra | Exhibition layout

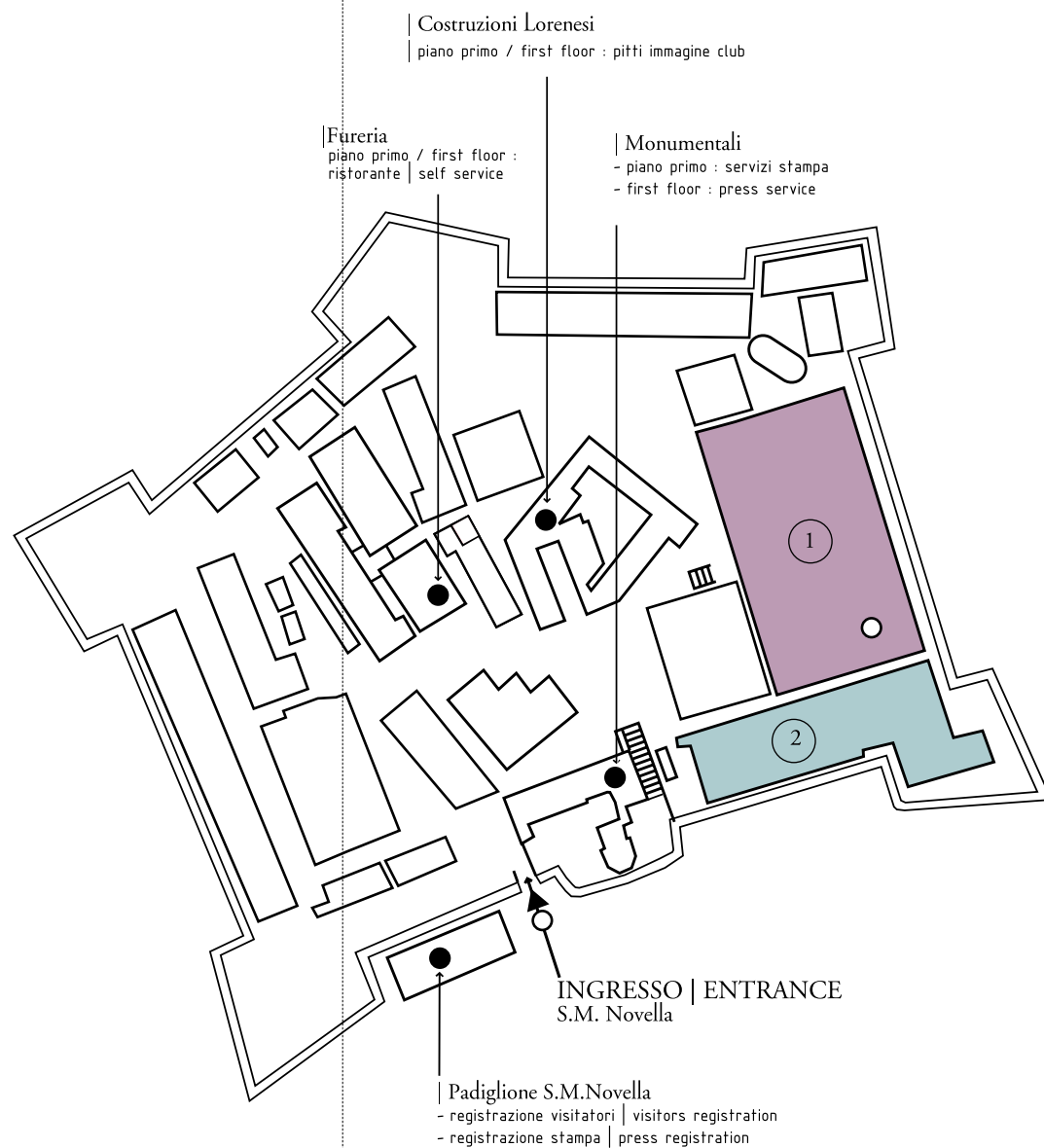

Pittì Filati
1 Padiglione Centrale / piano inferiore
Padiglione Centrale / piano terra

Fashion at Work
2 Padiglione Cavaniglia

Research Area
2 Padiglione Cavaniglia

○ In concomitanza con Pittì Immagine Filati, al piano attico del Padiglione Centrale, si svolge PRIMA - MODA TESSUTO
Pittì Immagine Filati is concomitantly with PRIMA - MODA TESSUTO Padiglione Centrale Top floor

II | Pitti Filati
 Padiglione Centrale | n. 1
 piano inferiore / lower floor

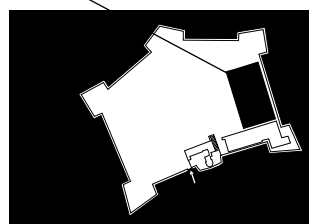
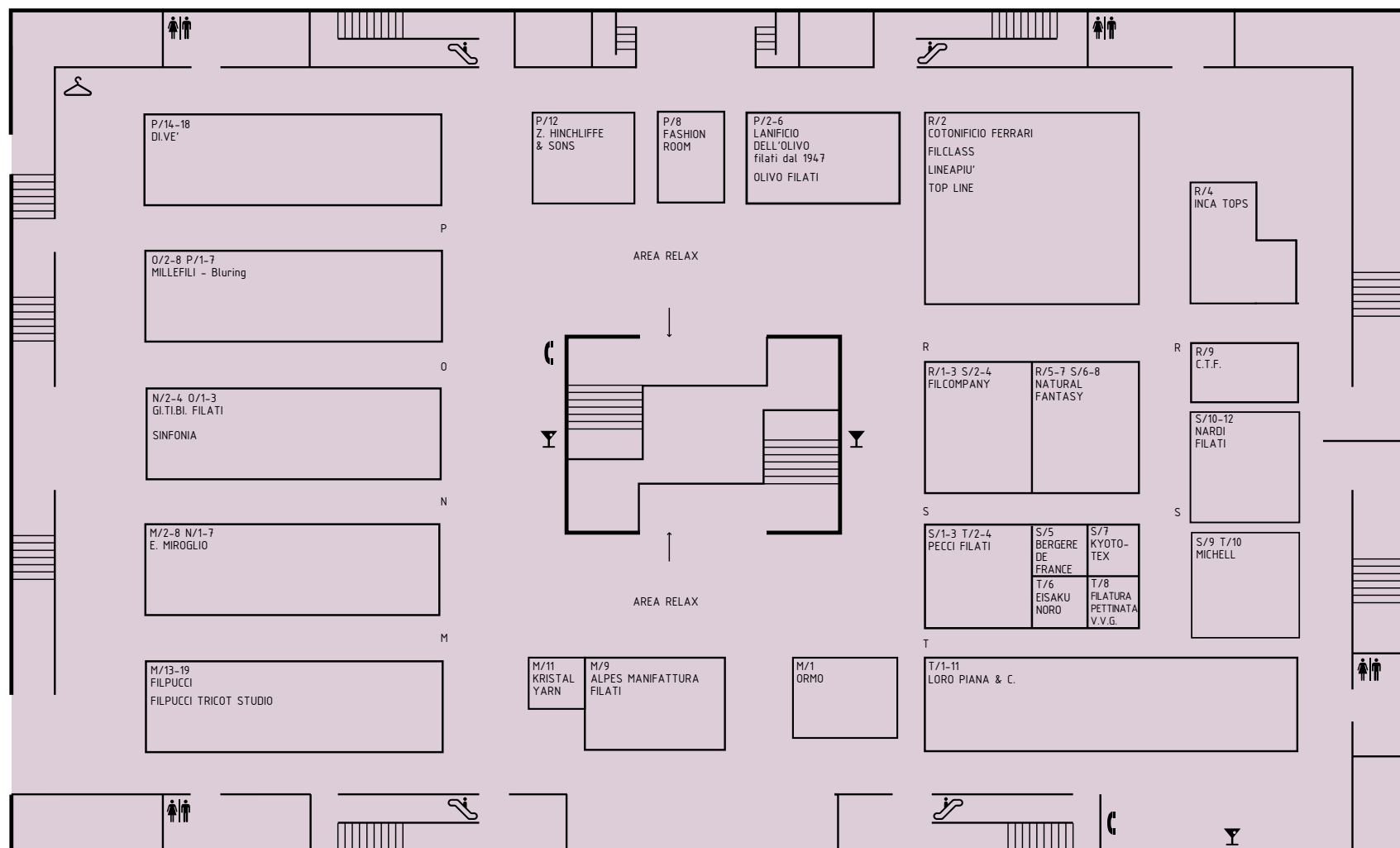

Pitti Filati

Padiglione Centrale | n. 1

piano terra / ground floor

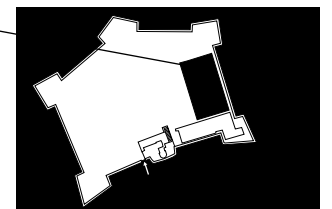
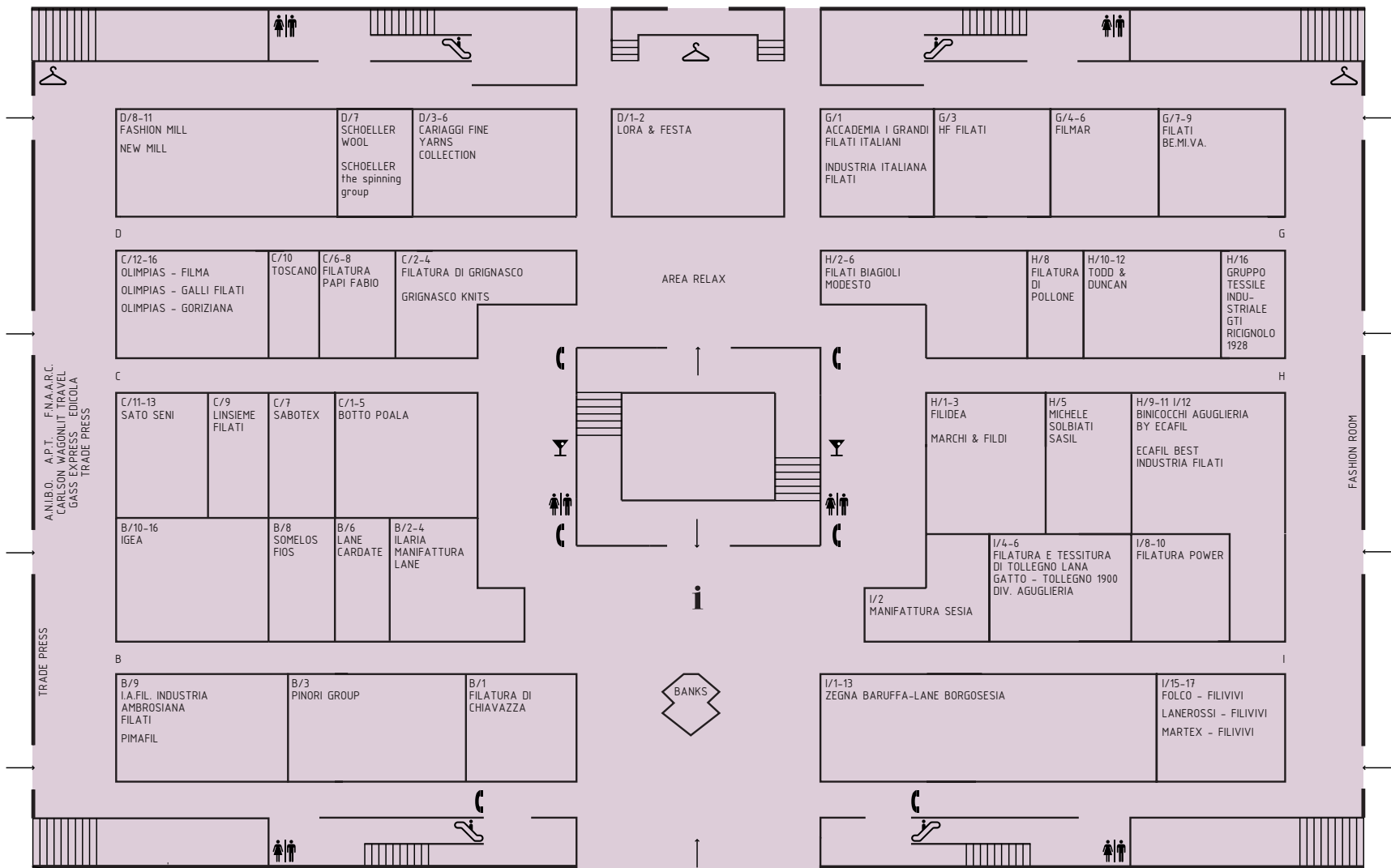

Fashion at Work
 Padiglione Cavaniglia | n. 2

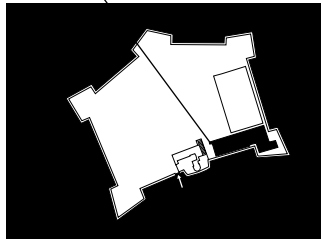
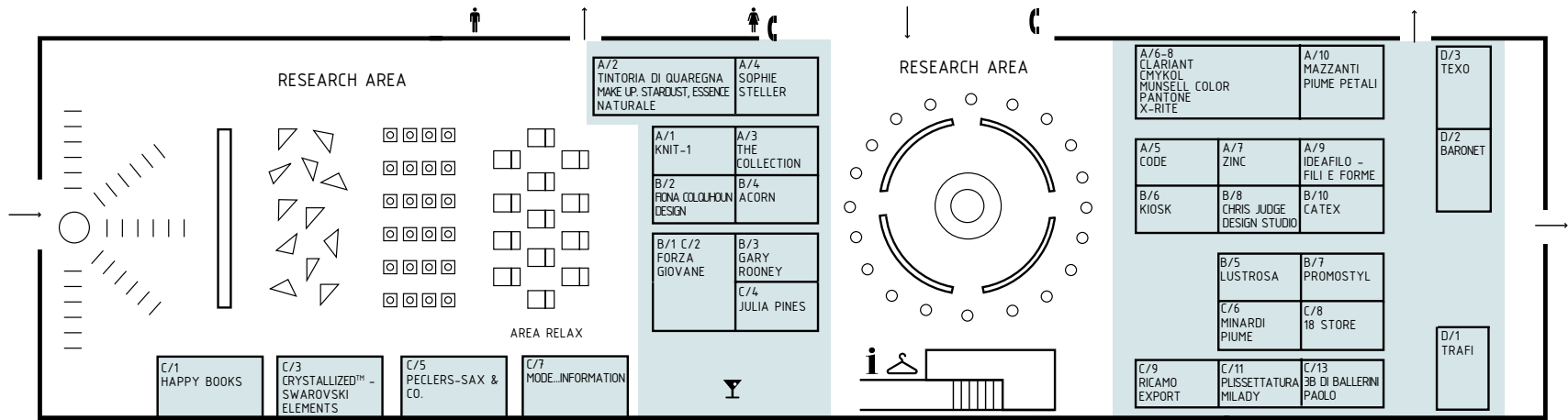

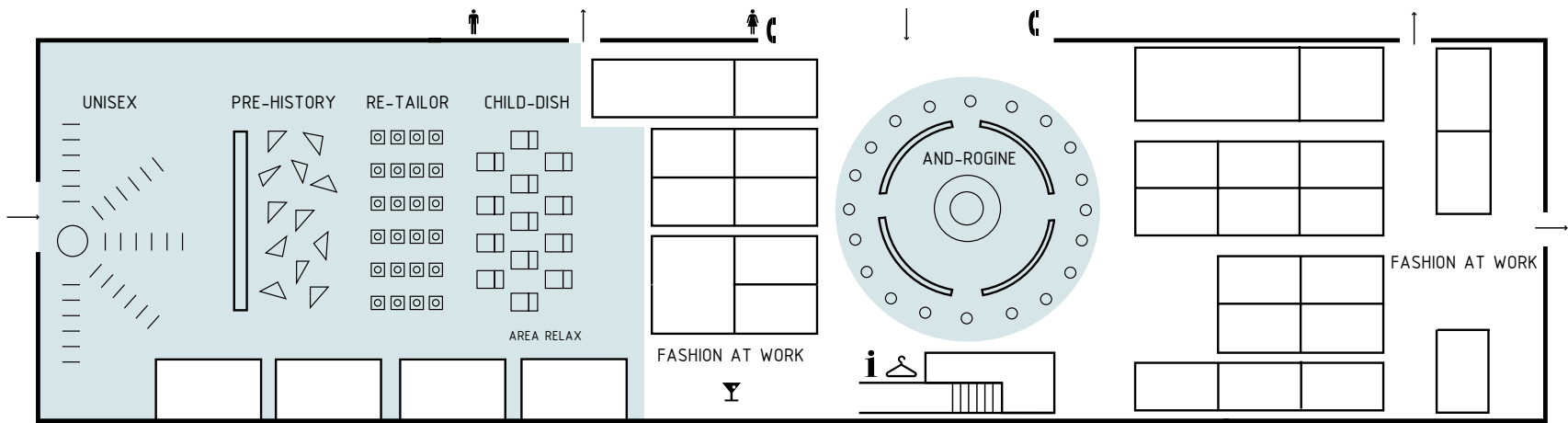

RESEARCH AREA

ITA → WHO-AND-I Il 65esimo Pitti Filati si interroga sulla propria identità e su quella dello spettatore. Una ricerca a ritroso verso le proprie origini, la propria matrice, il proprio originale che diventerà nuovo punto di partenza per il futuro. Il futuro della propria storia, della propria determinazione, della propria estetica. PRE-HE-STORY, trapassato futuro. RE-TAILOR, la sartoria ridefinita. CHIL-DISH, reperti d'infanzia. AND-ROGINE, fusione, confusione, evoluzione dell'XY. U-NISEX, annientamento della forma, sono i cinque temi per la stagione autunno/inverno 2010-2011.

ENG → WHO-AND-I The 65th edition of Pitti Filati will be asking questions about identities – its own and the spectator's. It will feature a study that reaches back towards its roots, its matrix and its essence which will become a new starting point leading towards the future – the future of its history, its determination and its esthetic. PRE-HE-STORY, a perfect Future. RE-TAILOR, tailoring redefined. CHIL-DISH, the archeology of childhood. AND-ROGINE, fusion, confusion and XY evolution. U-NISEX, the elimination of shape, are the five themes for the Autumn/Winter 2010-2011 season.

